

SECTION OF DITCH
From Station 48+00 to 51+00
No Scale

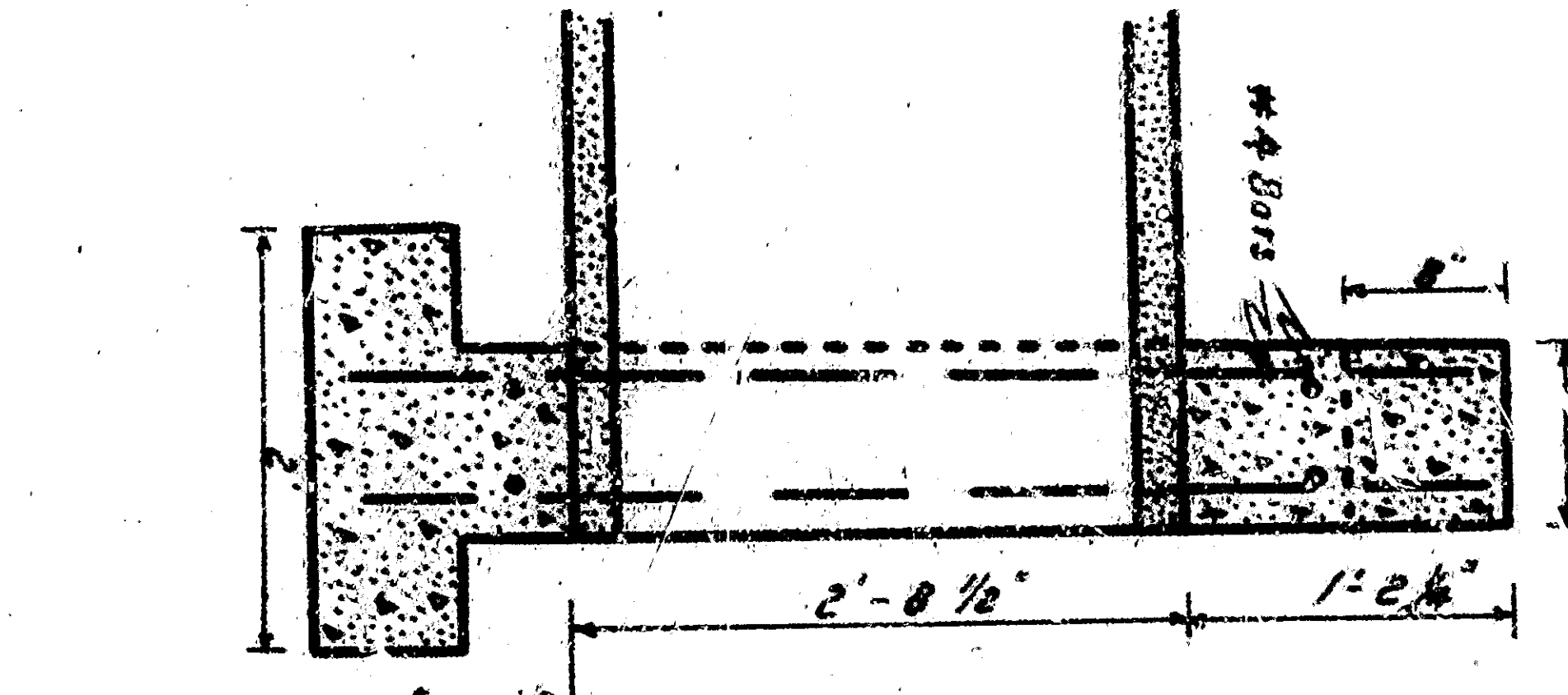

- NOTES**
- 1- Gates for Junction Box and Drop Inlet shall be Alhambra Foundry No. 4-1542 or equal, galvanized.
 - 2- Signs for Catch Basins to be Alhambra Foundry No. A-330 (galvanized) or 3" flange and schedule existing.

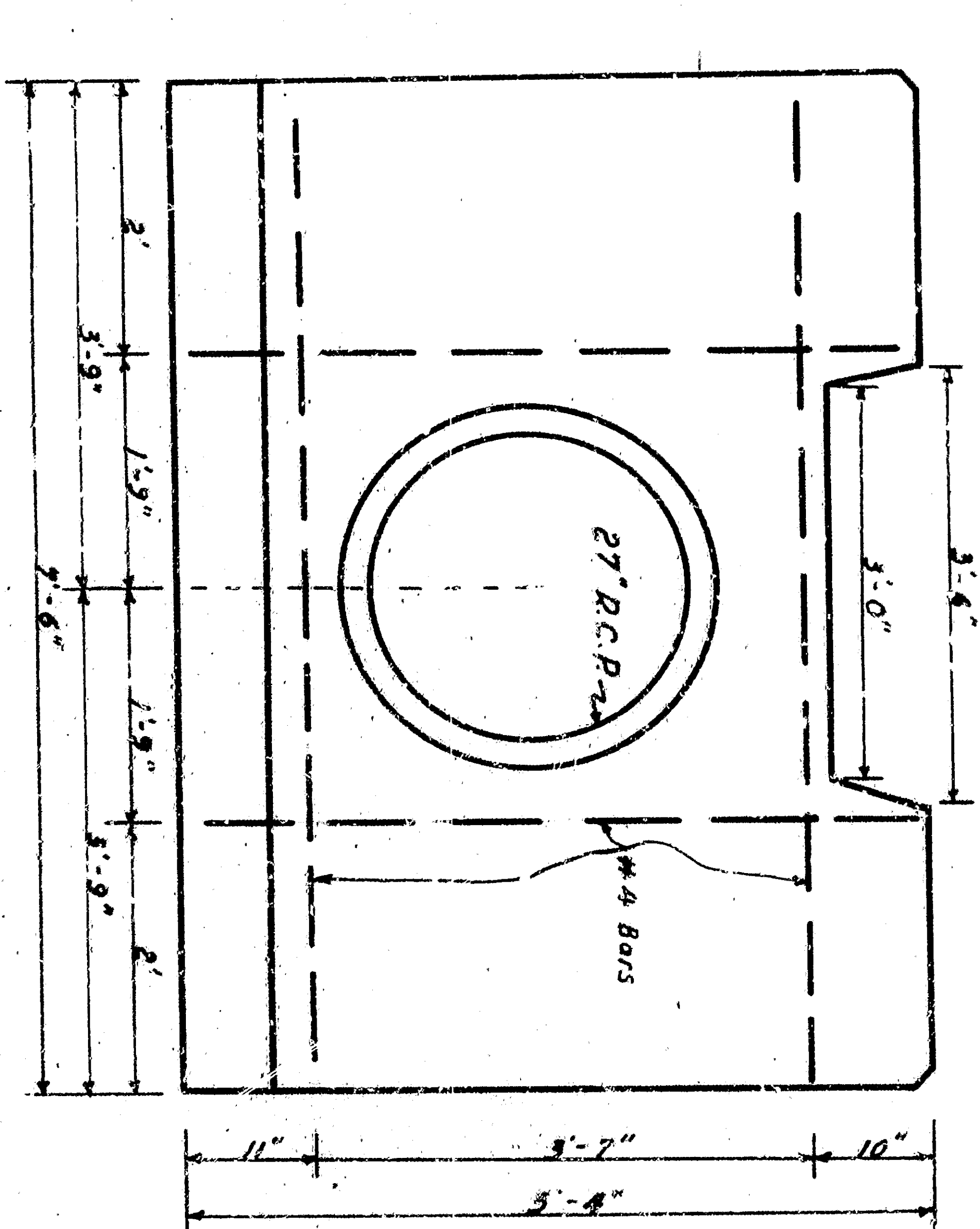
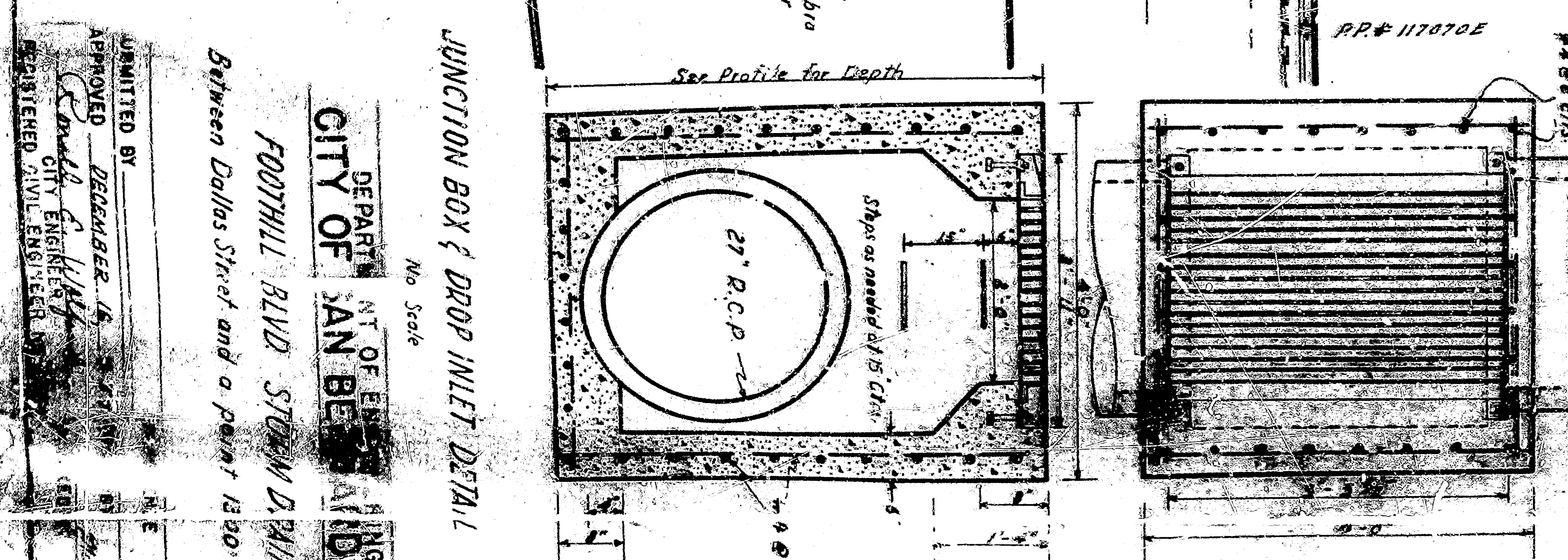

APPROVED BY: [Signature]
 DEPARTMENT OF ENGINEERING
 CITY OF SAN ANTONIO
 PLANNING AND DESIGN DIVISION
 Between Dallas Street and a point 1250 feet
 NORTH OF THE INTERSECTION OF
 FOOTHILL BLVD. STATION 48+00

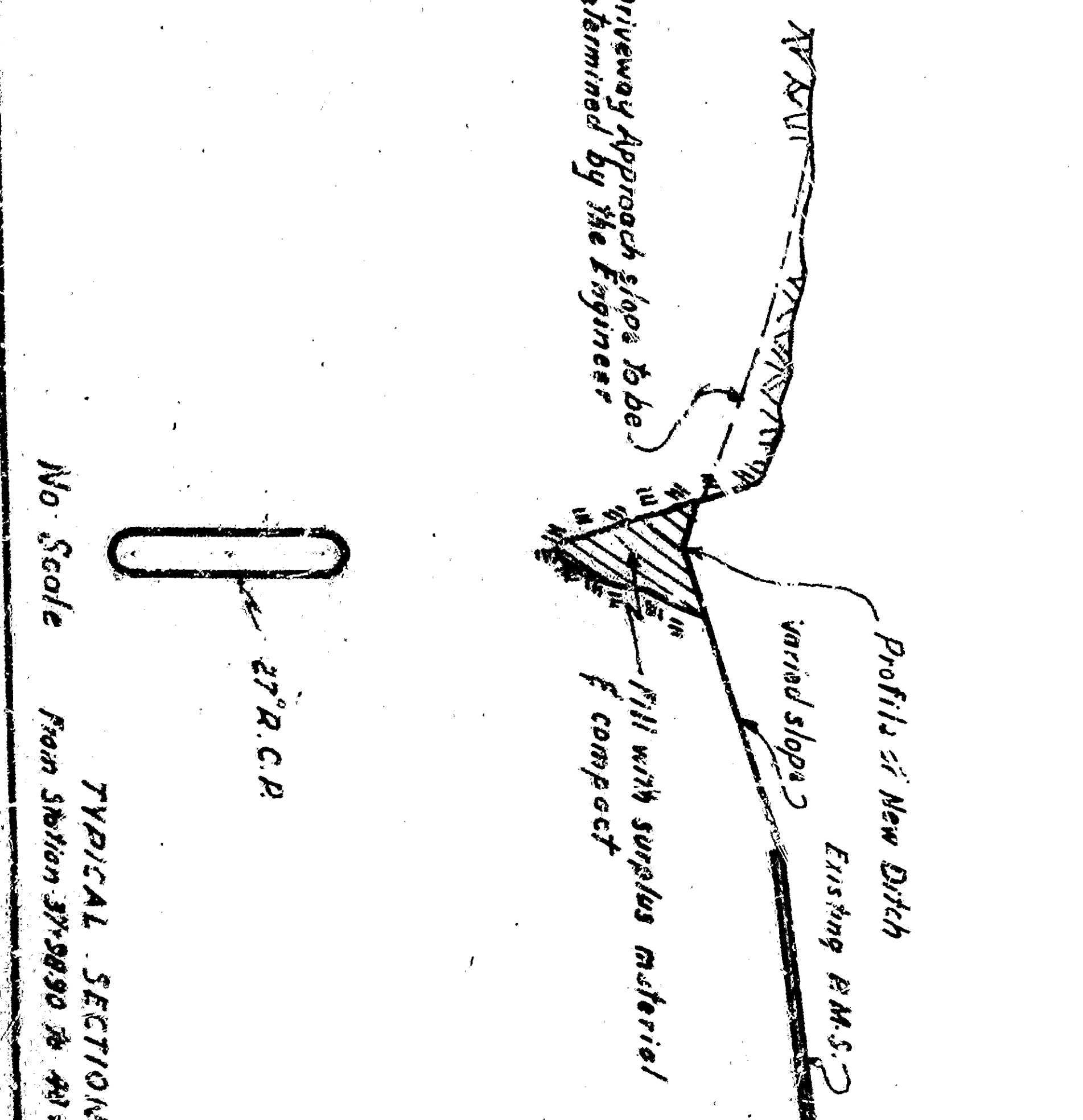
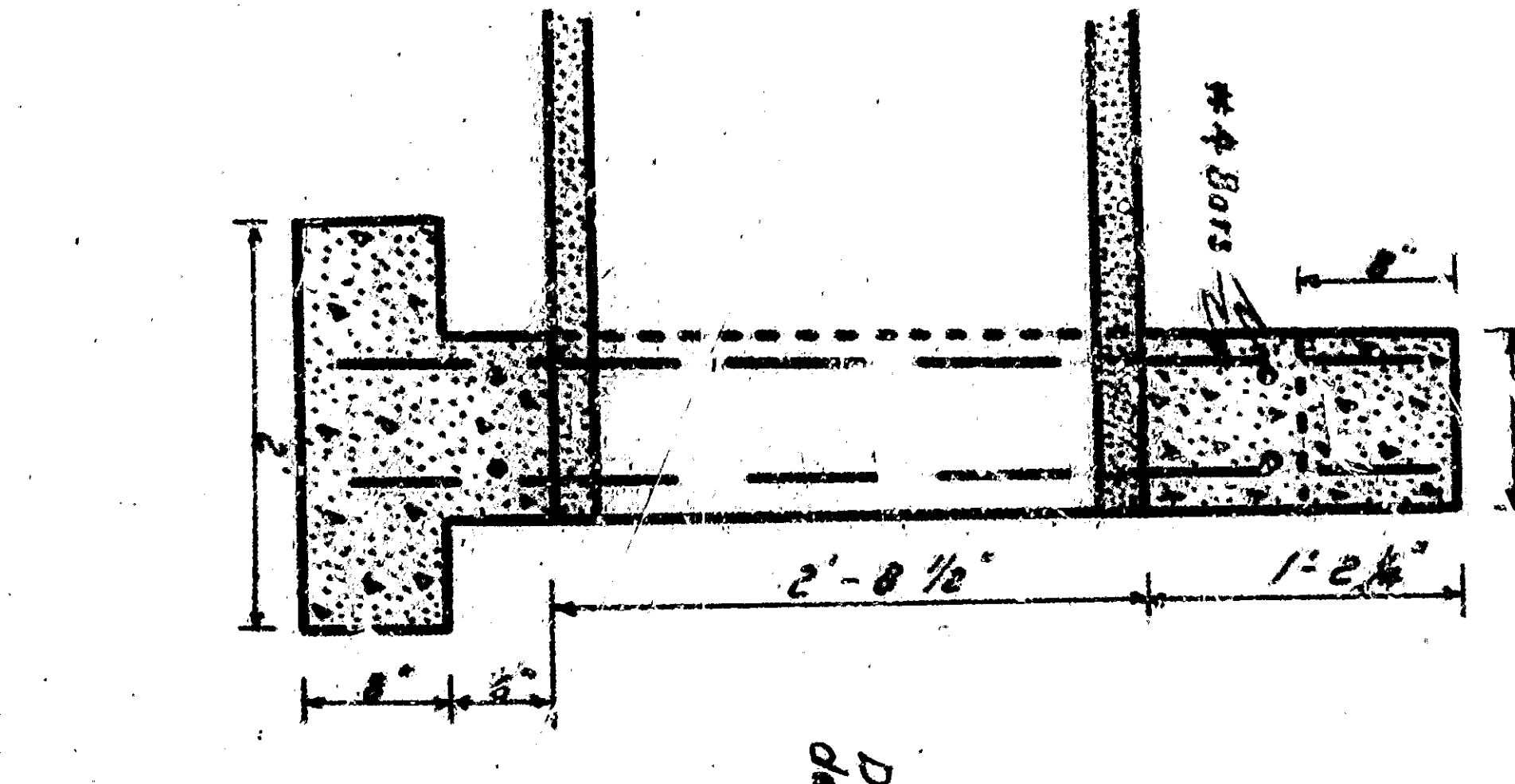
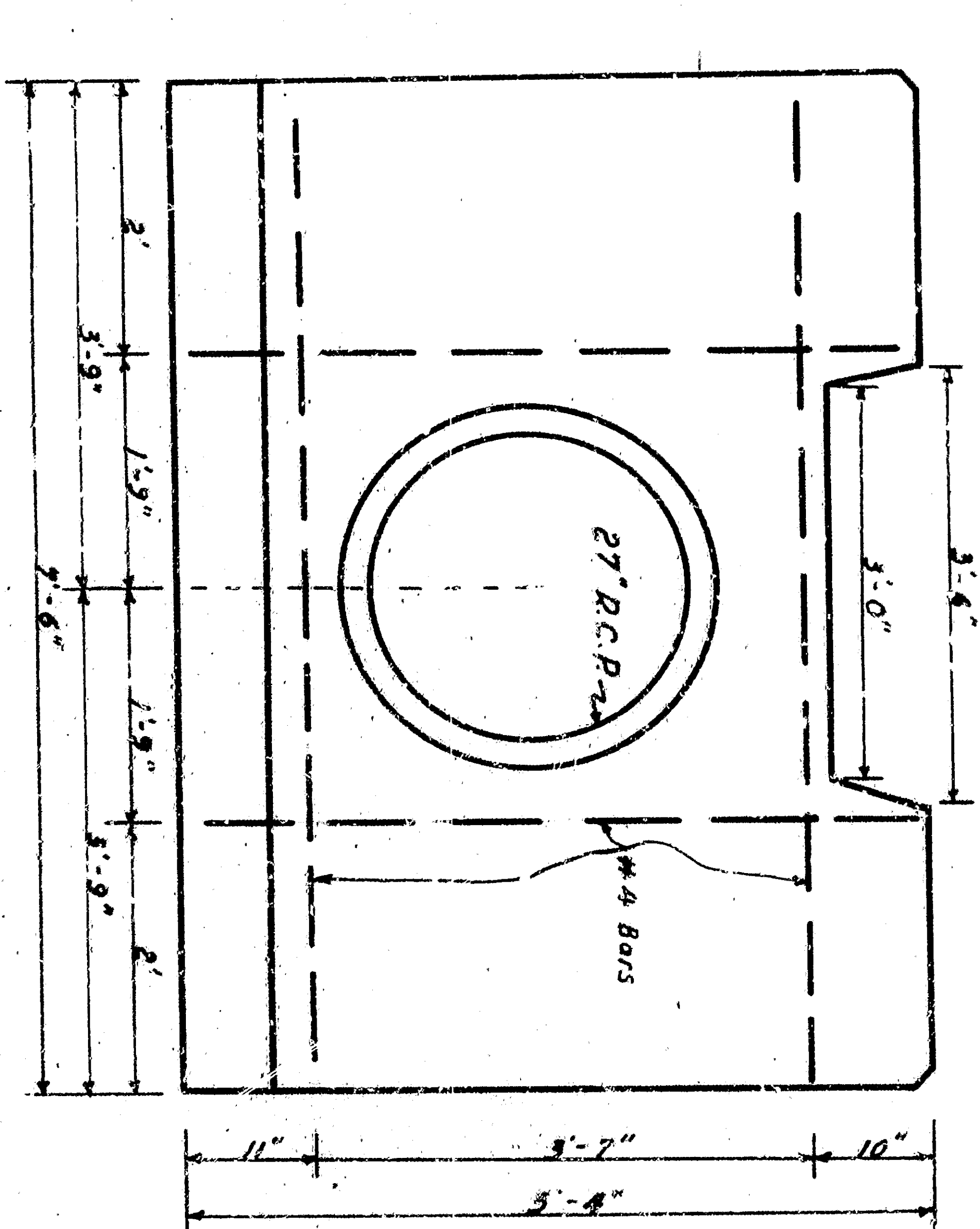
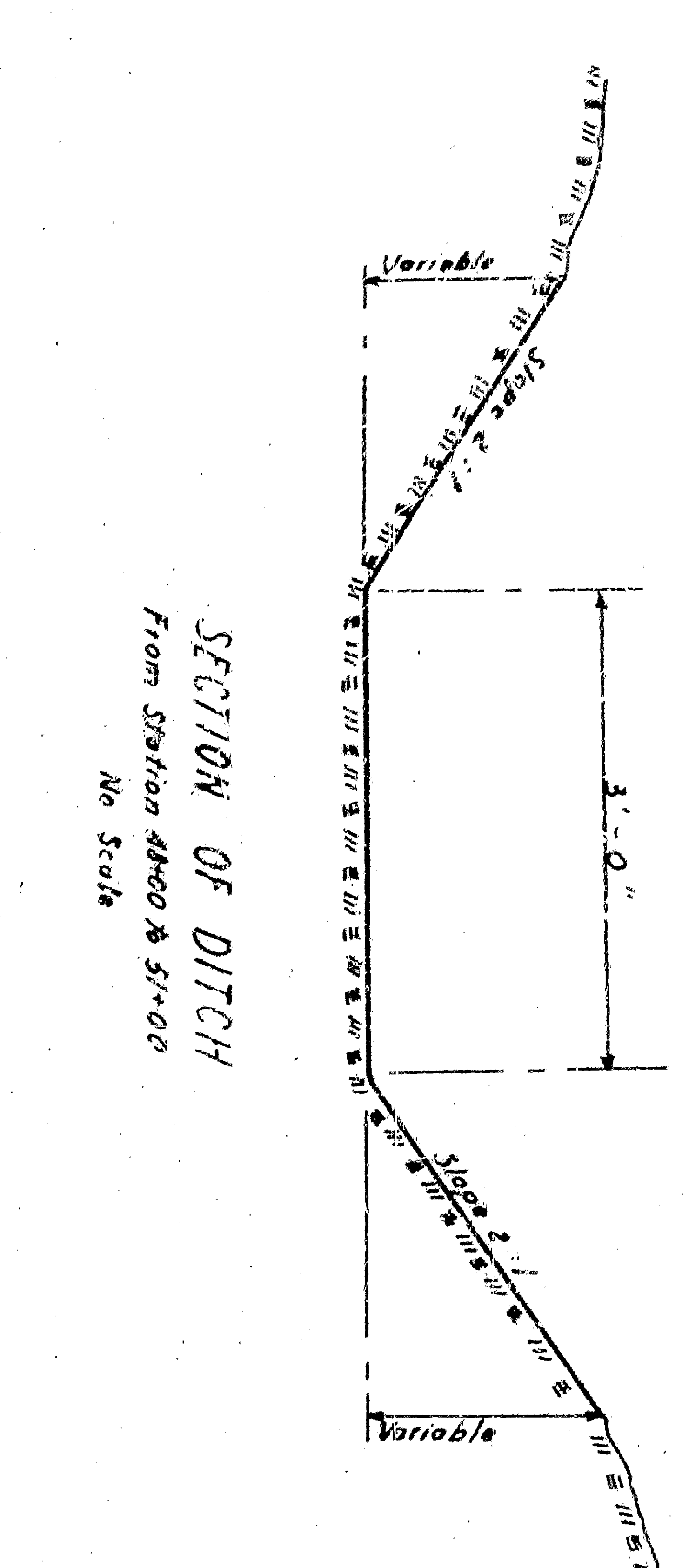

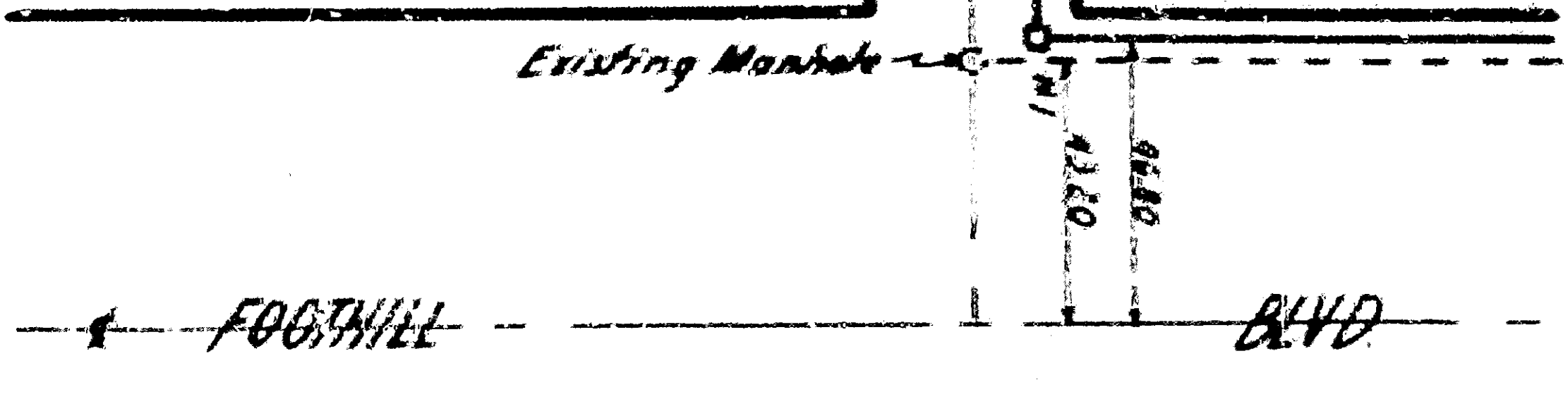
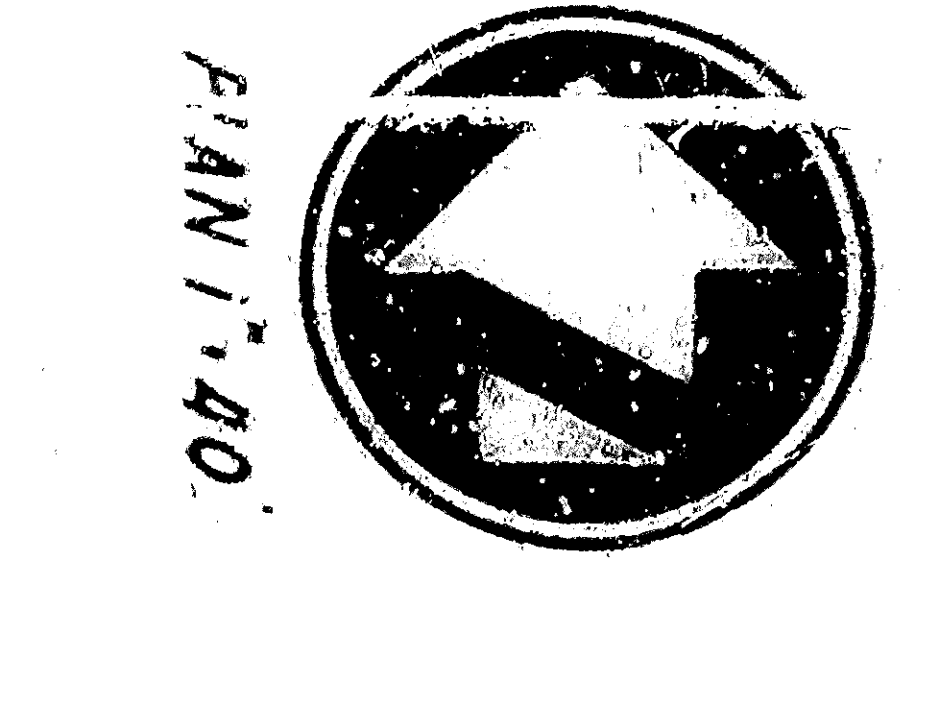

ENDWALL DETAIL
No Scale

NOTES

- 1- Gates for Junction Box and Drop Inlet shall be aluminum framed.
- 2- Signs for catch basins to be aluminum framed No. A-330 (galvanized) or 3" flange and schedule existing.
- 3- Flanges and schedule existing.

APPROVED BY: [Signature]
 DEPARTMENT OF PUBLIC WORKS
 CITY OF SAN ANTONIO
 ENGINEER: [Signature]
 BETWEEN DALLAS STREET AND A POINT 1250' FEET
 FOOTHILL BLVD. STATION 48+00 TO 51+00
 No Scale

